





# ROBINA CAMPUS MAP

94 Laver Drive Robina Qld 4226

All TAFE Queensland campuses are smoke free.

## GROUND LEVEL



-  Toilet Facilities
-  Wheelchair Access
-  Canteen/Food Service
-  Lifts
-  Customer Service Centre

**Note:** If you require a unisex accessible toilet facility please contact our Customer Service Centre.

**1300 308 233**

[tafeqld.edu.au](http://tafeqld.edu.au)

RTO 0275 | CRICOS 03020E | HEP PRV13003

**MAKE  
GREAT  
HAPPEN**



# ROBINA CAMPUS MAP

94 Laver Drive Robina Qld 4226

All TAFE Queensland campuses are smoke free.

## LEVEL 1

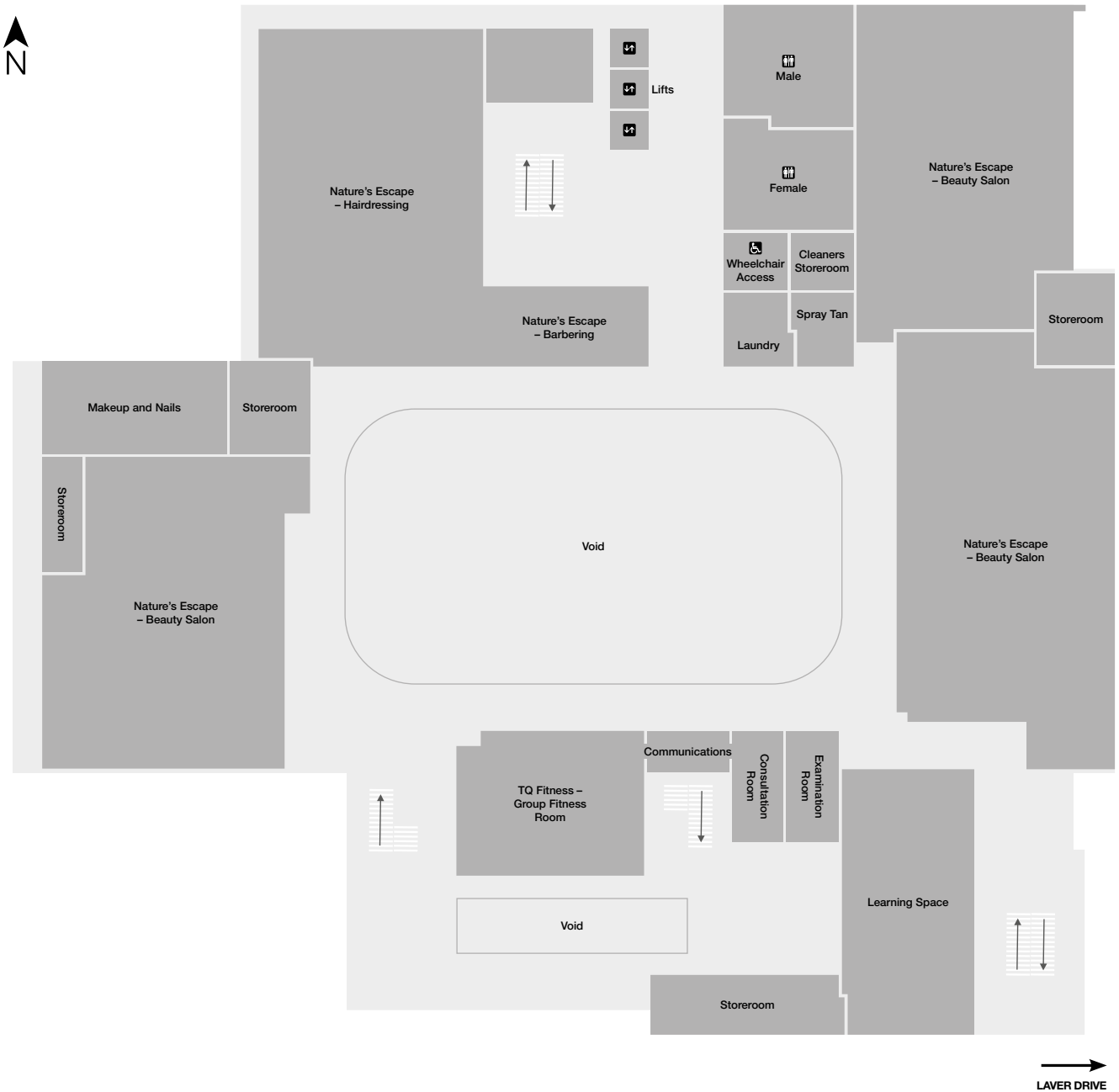

- Toilet Facilities
- Wheelchair Access
- Canteen/Food Service
- Lifts
- Customer Service Centre

**Note:** If you require a unisex accessible toilet facility please contact our Customer Service Centre.

**1300 308 233**

tafeqld.edu.au

RTO 0275 | CRICOS 03020E | HEP PRV13003

**MAKE GREAT HAPPEN**



# ROBINA CAMPUS MAP

94 Laver Drive Robina Qld 4226

All TAFE Queensland campuses are smoke free.

## LEVEL 2



- Toilet Facilities
- Wheelchair Access
- Canteen/Food Service
- Lifts
- Customer Service Centre

**Note: If you require a unisex accessible toilet facility please contact our Customer Service Centre.**

**1300 308 233**

[tafeqld.edu.au](http://tafeqld.edu.au)

RTO 0275 | CRICOS 03020E | HEP PRV13003

**MAKE GREAT HAPPEN**



# ROBINA CAMPUS MAP

94 Laver Drive Robina Qld 4226

All TAFE Queensland campuses are smoke free.

## LEVEL 3



- Toilet Facilities
- Wheelchair Access
- Canteen/Food Service
- Lifts
- Customer Service Centre

**Note:** If you require a unisex accessible toilet facility please contact our Customer Service Centre.

**1300 308 233**  
[tafeqld.edu.au](http://tafeqld.edu.au)

RTO 0275 | CRICOS 03020E | HEP PRV13003

**MAKE GREAT HAPPEN**



# ROBINA CAMPUS MAP

94 Laver Drive Robina Qld 4226

All TAFE Queensland campuses are smoke free.

## LEVEL 4

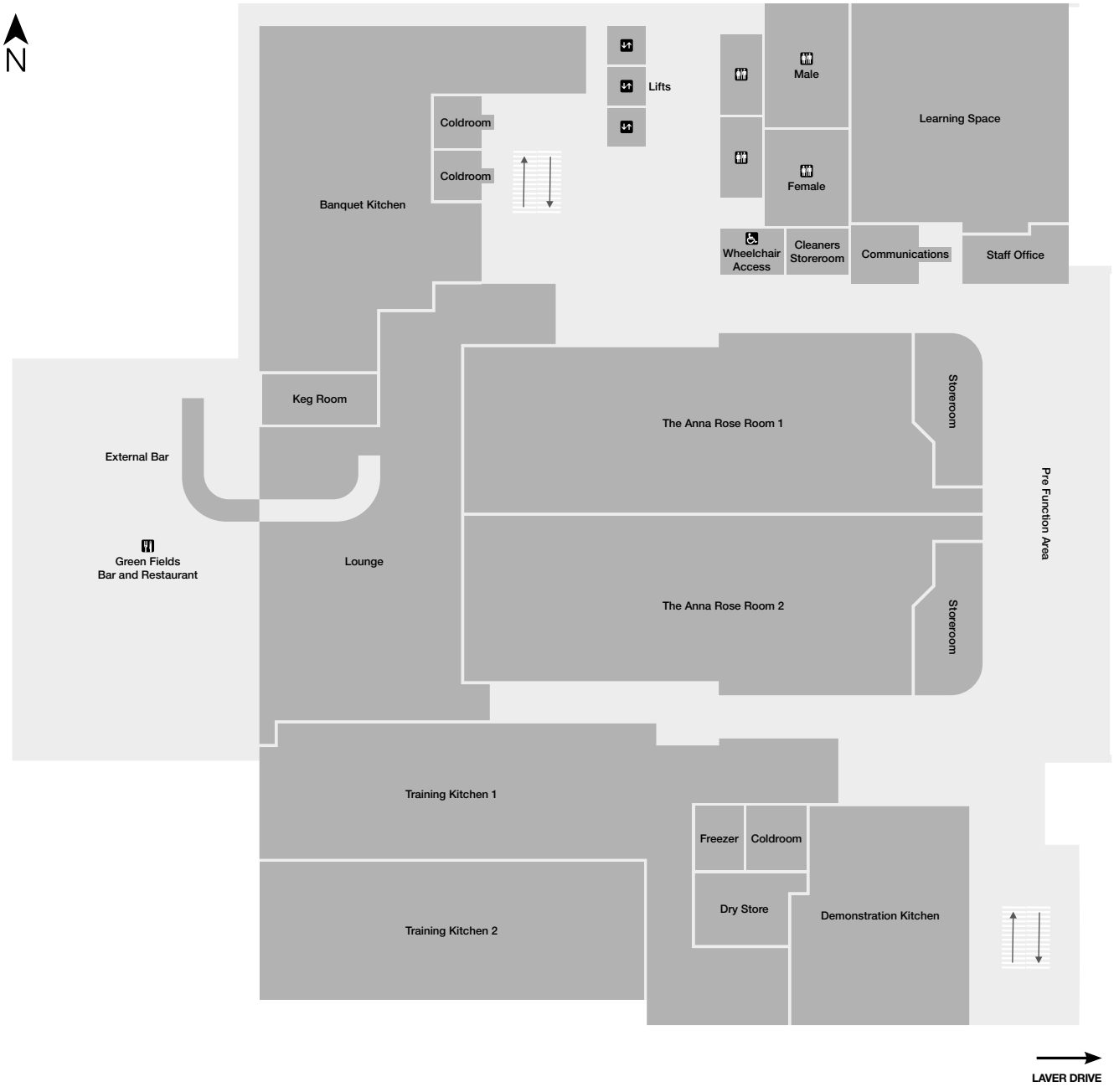

- Toilet Facilities
- Wheelchair Access
- Canteen/Food Service
- Lifts
- Customer Service Centre

**Note:** If you require a unisex accessible toilet facility please contact our Customer Service Centre.

**1300 308 233**  
 tafeqld.edu.au

RTO 0275 | CRICOS 03020E | HEP PRV13003

**MAKE GREAT HAPPEN**

